

O-Fury

High-end Energy-saving LED Display

Applications



Key Features



Energy Saving
Eye Protection



Front / Rear
Access



High
Refresh Rate



High
Brightness



Wide
Viewing Angle



Fanless

O-Fury series Specification

Model	O-Fury P3.9	O-Fury P4.8	O-Fury P6.25	O-Fury P7.81	O-Fury P10.4
Pixel Pitch	3.91mm	4.81mm	6.25mm	7.8125mm	10.416mm
Pixel Density (pixels/m ²)	65,536	43,264	25,600	16,384	9,216
LED Type	SMD1921	SMD1921	SMD2727	SMD2727	SMD2727
LED Configuration	1R 1G 1B				
Module Material	Plastic				
Cabinet Material	Aluminum alloy				
Module Connection	Connectors / Cable free				
Module Size (WxHxD)	500x250 mm				
Module Resolution (pixels)	128x64	104x52	80x40	64x32	48x24
Cabinet Size (mm)	1000x1000x83mm as standard, 1000x750mm / 1000x500mm or customized available				
Cabinet Resolution (pixels)	256x256	208x208	160x160	128x128	96x96
Recommend Viewing Distance	>3m	>4m	>6m	>8m	>10m
Scan Mode	1/16 scan	1/13 scan	1/8 scan	1/4 scan	1/2 scan
Brightness (nits)	6,000				
Refresh Rate (HZ)	1,920 / 3,840				
Contrast Ratio	8,000 : 1				
Max. Power Consumption (W/m ²)	650				
Avg. Power Consumption (W/m ²)	100-200				
Weight (kg/panel)	22.5				
Speical Shape Installation	Flat or curve installation (90° ≤ x ≤ 180°)				
Color Temperature	8,000 K as standard (3,200-9,000K adjustable)				
Frame Frequency (HZ)	50/60				
AC Input Voltage	110-220V ±10%				
Viewing Angle (°)	160/140 (H/V)				
Operating Temperature (°C)	-10°C~+40°C				
Storage Temperature (°C)	-20°C~+50°C				
Operating Humidity	10%~95%				
Dead Pixel Rate	<0.0003				
Lift Span	100,000 hours				
Ingress Protection	IP65 front and rear				
Operating Environment	Outdoor use suggested				
Service	Front/Rear access				
Certificate	CE , EMC, LVD, FCC, ROHS				

Note: Specifications are for reference only and are subjected to change without notice.

Product Dimension

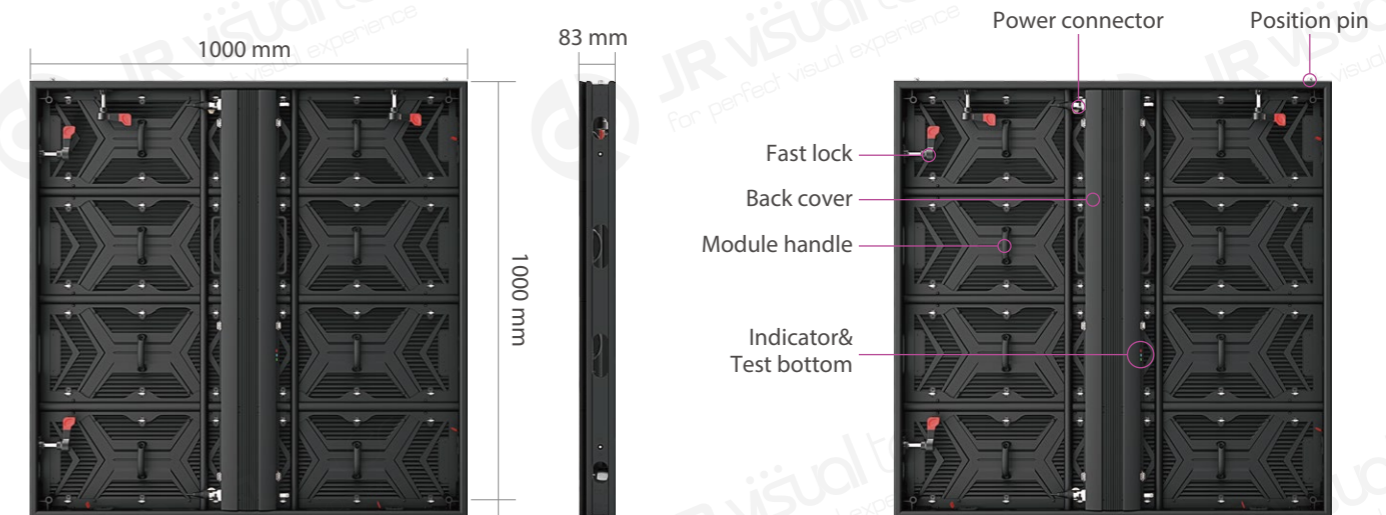

Front side

Matte corrugation module mask achieves ultra-high contrast.

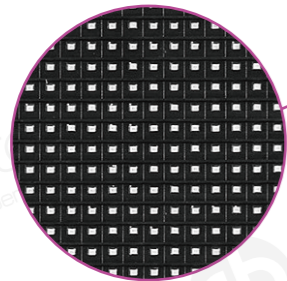

Back side

- Aluminum profile cabinet is light weight, which saves transportation cost and installation cost.
- IP65 Waterproof for both front and back side

Weight is 35% lighter

Weight 22.5kg



Full-front and Rear maintenance

Suits for all outdoor applications

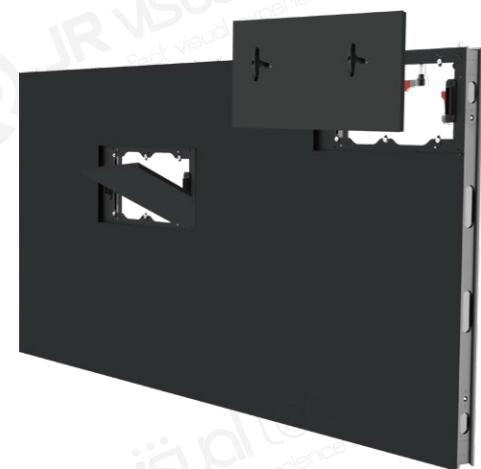

Seamless splicing

- Delicate structure
- Seamless splicing
- Perfect flatness



Fast installation

Stainless fast lock High precision aluminum alloy panel
Quick assembly, Good flatness.

Stainless steel lock catch

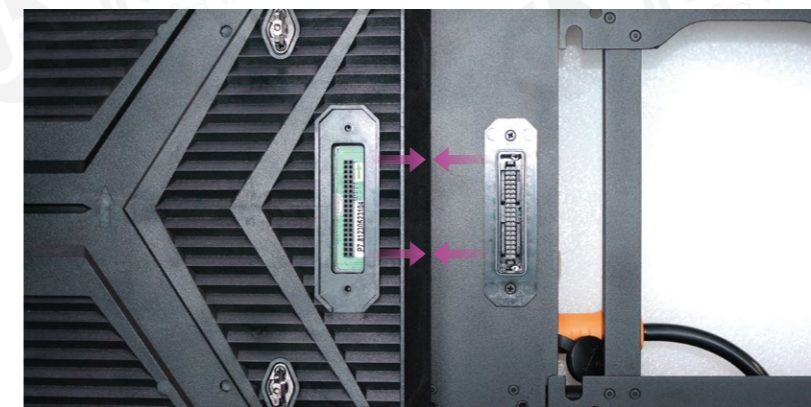
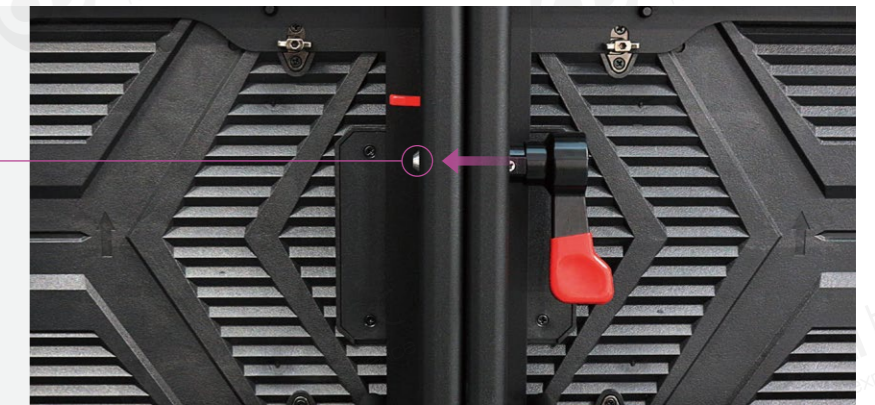

Hot-swapping

Hard connection supports full front access.

Project Case

