

## Product Overview

Intelligent Dynamic Display Series - composed of multiple rotating units stacked into integrated display modules. These modular carriers can be arranged to create stunning visual effects such as spiral motion, oscillation, and synchronized rotation, enhancing the exhibit with dynamic, captivating brilliance.

## JR VISUAL TEC LIMITED

[www.jrvisualtec.com](http://www.jrvisualtec.com) [info@jrvisualtec.com](mailto:info@jrvisualtec.com) +86 136 3251 7086 [@jrvisualtec](https://www.facebook.com/jrvisualtec) [@jrvisualtec](https://www.linkedin.com/company/jrvisualtec)

Building 9, XinMu Innovative Industrial Park, PingHu Street, LongGang District, Shenzhen, China



## Kinetic Rotating LED Display

LEDs in Motion



**Model No.1**

**Delta-Wing Rotating Matrix LED Display**



-   
Simple maintenance
-   
Support customization
-   
High operational stability
-   
Stable and reliable
-   
Flexible action editing
-   
Support central control invocation
-   
Support infinite rotation
-   
Simple and convenient installation

**Specification**

Items	Description	Specification
<b>Display &amp; Dimension</b>	LED Display Model	Indoor P2mm LED Display ( Optional pixel pitch: P1.2, P1.5, P1.8 )
	LED Module Size	320 x 160mm
	Number of the Layers	8 ( Can be Customized )
	Number of the Units	Multiple Units can be Spliced and Displayed Simultaneously
	Each Unit Dimension	Closure State: ( Length: 800mm; Height: 3099mm ) Unfolding State: ( Length: 2400mm; Height: 3099mm )
	Display Surfaces	Closure State: 3 display surfaces   Unfolding State: 1 display surface
	Each Layer Display Size	Closure State: 3 pcs 800x320mm   Unfolding State: 1pcs 2400 x 320mm
	Whole Display Size	2,400 x 2,560 mm ( WxH )
	Whole Display Resolution	1,200 x 1,280 pixels ( WxH )
	Gap between Each Layer	5mm
<b>Control &amp; Script</b>	Net Weight	LED Display: 460 kgs   Base: 350kgs
	Gross Weight	LED Display: 640 kgs   Base: 445kgs
	Moving Range	Triangle shape unfolding and close; 360° unlimited rotation
	Motion Mode	Built-in motion scripts ( user-editable ) Or with software-adjustable motion script parameters
	Operation Speed	The rotation and opening / closing speeds are adjustable via the control program
	Control Category	Network-based control via TCP/IP protocol
	Video Binding Capability	Yes ( 1 video file per motion script )
<b>Power &amp; Installation</b>	Multi-Script Support	Yes ( Multiple videos can be mapped to multiple motion scripts )
	Protocol Support	External UDP-based invocation protocol
	Self-Recovery Functionality Supported	Software-enabled automatic error detection and clearance
	Power Input	AC 110 ~ 240V, 50/60HZ
	Max. Power Consumption	6.5 KW
	Signal Transmission	CAT 6
Installation		Factory Configuration: Display panel and base shipped as separate units. Installation requires upright positioning of panel followed by screw-fastening to base

# Product in Action

( Delta-Wing Rotating Matrix LED Display )

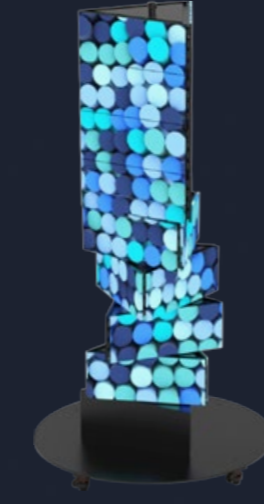
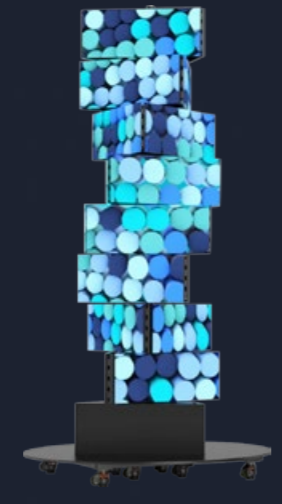
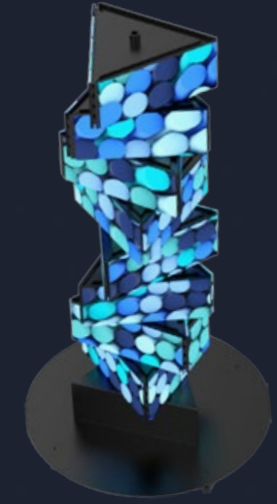
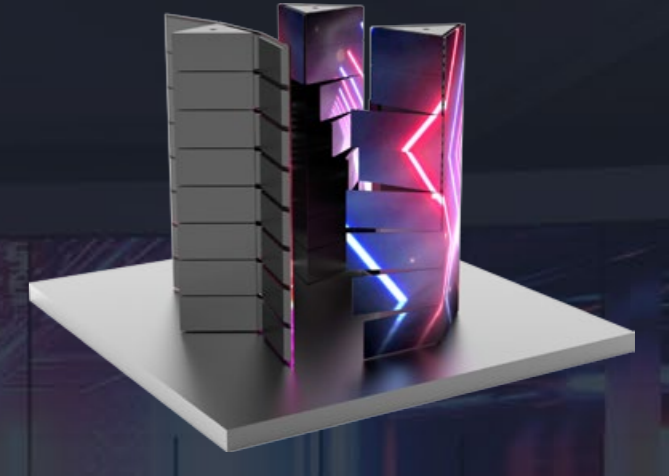
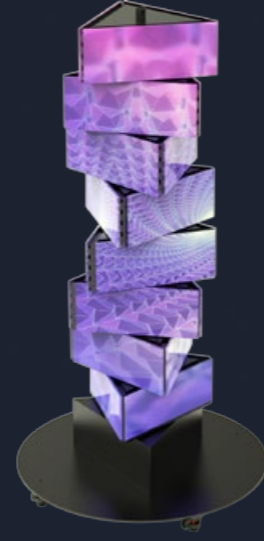
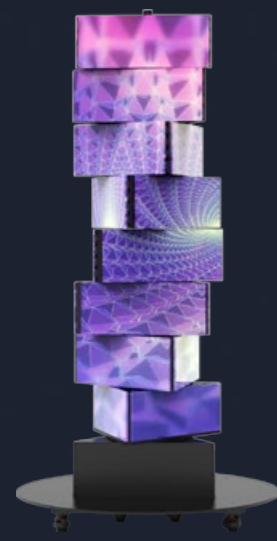

## Model No.2

# Double-Sided Curve Kinetic DNA LED Display



Simple maintenance



Support customization



High operational stability



Stable and reliable



Flexible action editing



Support central control invocation



Support infinite rotation



Simple and convenient installation



## Specification

Items	Description	Specification
LED Display Model		Indoor P2mm LED Display ( Optional pixel pitch: P1.2, P1.5, P1.8 )
LED Module Size		320 x 160mm Flexible LED Module
Number of the Layers		6 ( Can be Customized )
Number of the Units		10 ( Can be Customized )
Number of the Units		Multiple Units can be Spliced and Displayed Simultaneously
Each Unit Dimension		Length: 1,4050mm; Thickness: 280mm; Height: 2,2980mm
Each Unit Dimension		Length: 1,4050mm; Thickness: 280mm; Height: 3,600mm.
Display Surfaces		Double sides with Curve LED Display
Each Layer Display Size		1,280 x 320mm
Whole Display Size		1,280 x 1,920 mm ( WxH ), 2 sides
Whole Display Size		1,280 x 3,200 mm ( WxH ), 2 sides
Whole Display Resolution		640 x 960 pixels ( WxH ) x 2
Whole Display Resolution		640 x 1,600 pixels ( WxH ) x 2
Gap between Each Layer		2mm
Gap between Each Layer		2mm
Net Weight		LED Display: 258 kgs   Base: 200 kgs
Net Weight		LED Display: 430 kgs   Base: 25 kgs
Gross Weight		LED Display: 370 kgs   Base: 260kgs
Gross Weight		LED Display: 614 kgs   Base: 319 kgs
Moving Range		360° unlimited rotation
Motion Mode		Built-in motion scripts ( user-editable ) Or with software-adjustable motion script parameters
Operation Speed		The rotation and opening / closing speeds are adjustable via the control program
Control Category		Network-based control via TCP/IP protocol
Video Binding Capability		Yes ( 1 video file per motion script )
Multi-Script Support		Yes ( Multiple videos can be mapped to multiple motion scripts )
Protocol Support		External UDP-based invocation protocol
Self-Recovery Functionality Supported		Software-enabled automatic error detection and clearance
Power Input		AC 110 ~ 240V, 50/60HZ
Max. Power Consumption		4.5 KW
Max. Power Consumption		7.5 KW
Signal Transmission		CAT 6
Installation		Factory Configuration: Display panel and base shipped as separate units. Installation requires upright positioning of panel followed by screw-fastening to base

### Display & Dimension

### Control & Script

### Power & Installation

# Product in Action

( Double-Sided Curve Kinetic DNA LED Display )

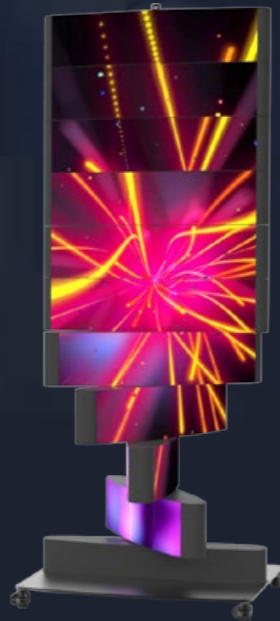
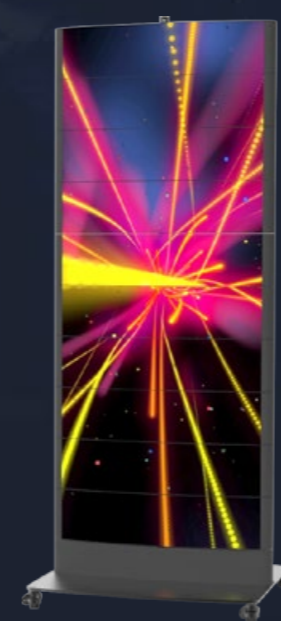
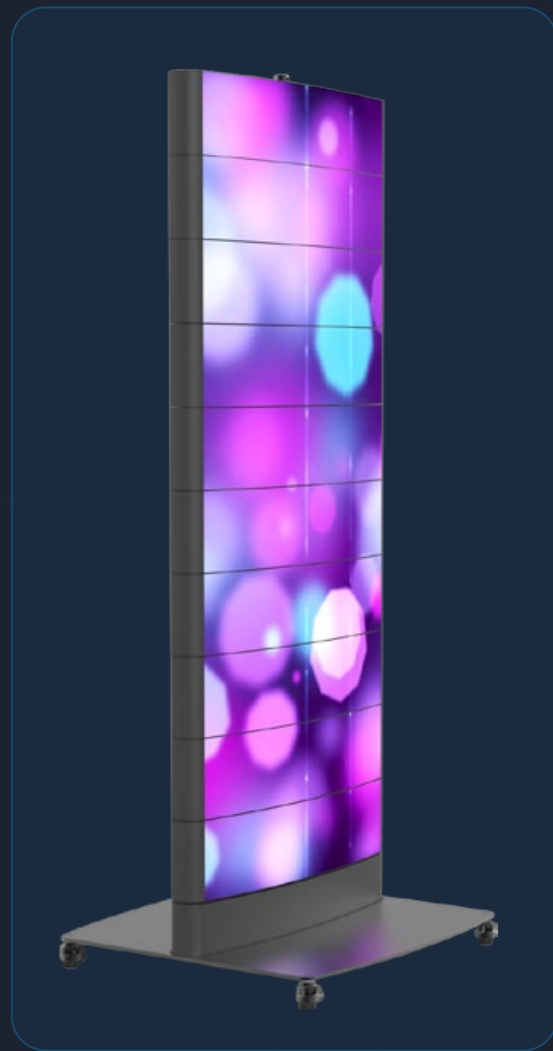

## Model No.3

# Double-Sided Kinetic DNA LED Display

Both sides with LED Display



Simple maintenance



Support customization



High operational stability



Stable and reliable



Flexible action editing



Support central control invocation



Support infinite rotation



Simple and convenient installation

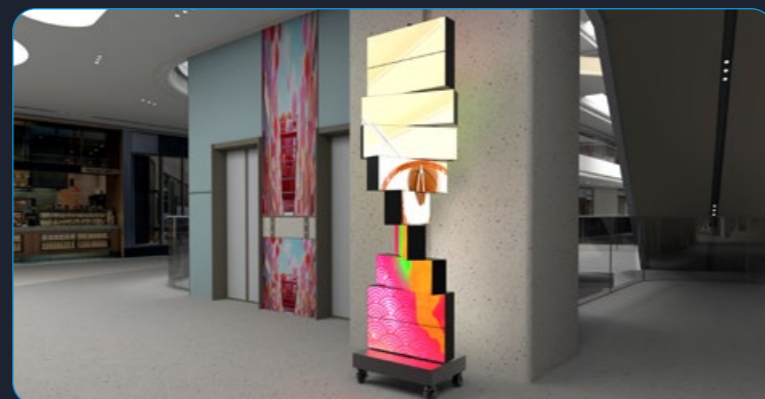
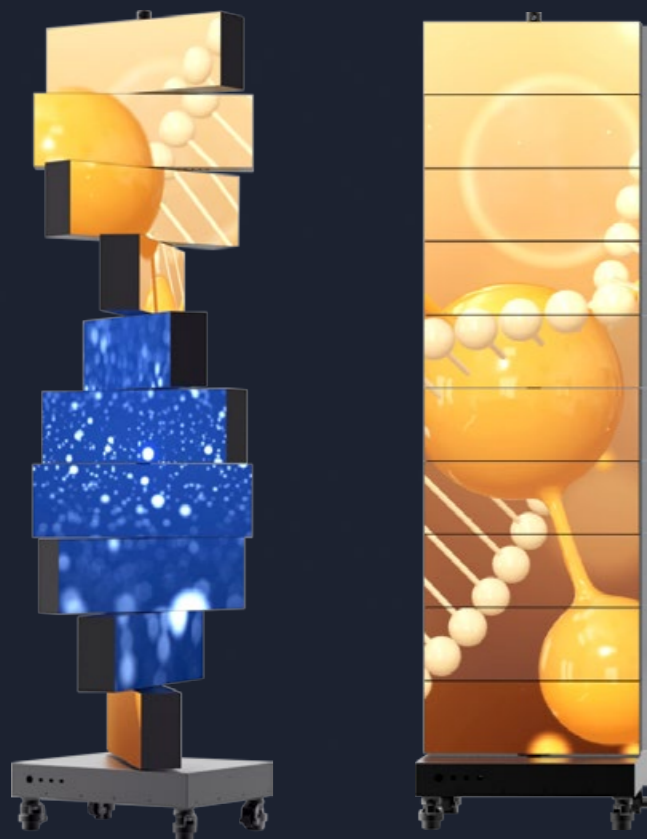

## Specification



Items	Description	Specification
	LED Display Model	Indoor P1.953mm LED Display
	LED Module Size	250 x 250mm
	Number of the Layers	10 ( Can be Customized )
	Number of the Units	Multiple Units can be Spliced and Displayed Simultaneously
	Each Unit Dimension	Length: 754mm; Thickness: 138mm; Height: 2830mm.
	Display Surfaces	Double sides with LED Display
	Each Layer Display Size	750 x 250mm
	Whole Display Size	750 x 2,500 mm ( WxH ), 2 sides
	Whole Display Resolution	384 x 1,280 pixels ( WxH ) x 2
	Gap between Each Layer	2mm
	Net Weight	LED Display: 190 kgs   Base: 86 kgs
	Gross Weight	LED Display: 265 kgs   Base: 121 kgs
	Moving Range	360° unlimited rotation
	Motion Mode	Built-in motion scripts ( user-editable ) Or with software-adjustable motion script parameters
	Operation Speed	The rotation and opening / closing speeds are adjustable via the control program
	Control Category	Network-based control via TCP / IP protocol
	Video Binding Capability	Yes ( 1 video file per motion script )
	Multi-Script Support	Yes ( Multiple videos can be mapped to multiple motion scripts )
	Protocol Support	External UDP-based invocation protocol
	Self-Recovery Functionality Supported	Software-enabled automatic error detection and clearance
	Power Input	AC 110 ~ 240V, 50/60HZ
	Max. Power Consumption	3.5 KW
	Signal Transmission	CAT 6
	Installation	Factory Configuration: Display panel and base shipped as separate units. Installation requires upright positioning of panel followed by screw-fastening to base

### Display & Dimension

### Control & Script

### Power & Installation

# Product in Action

( Double-Sided Kinetic DNA LED Display )

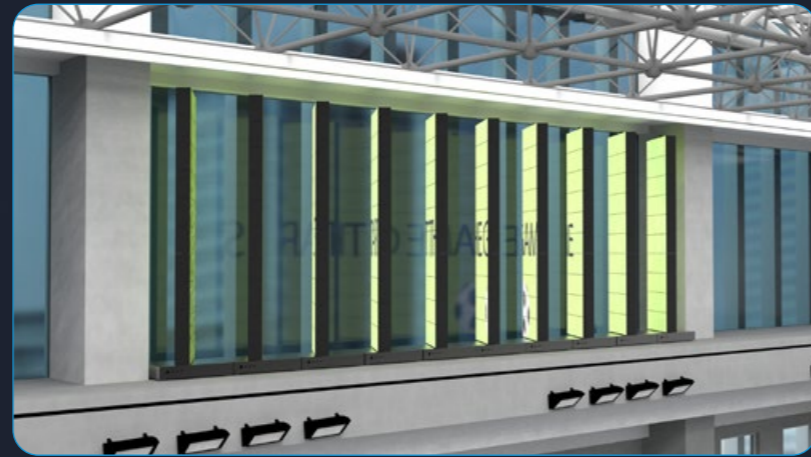
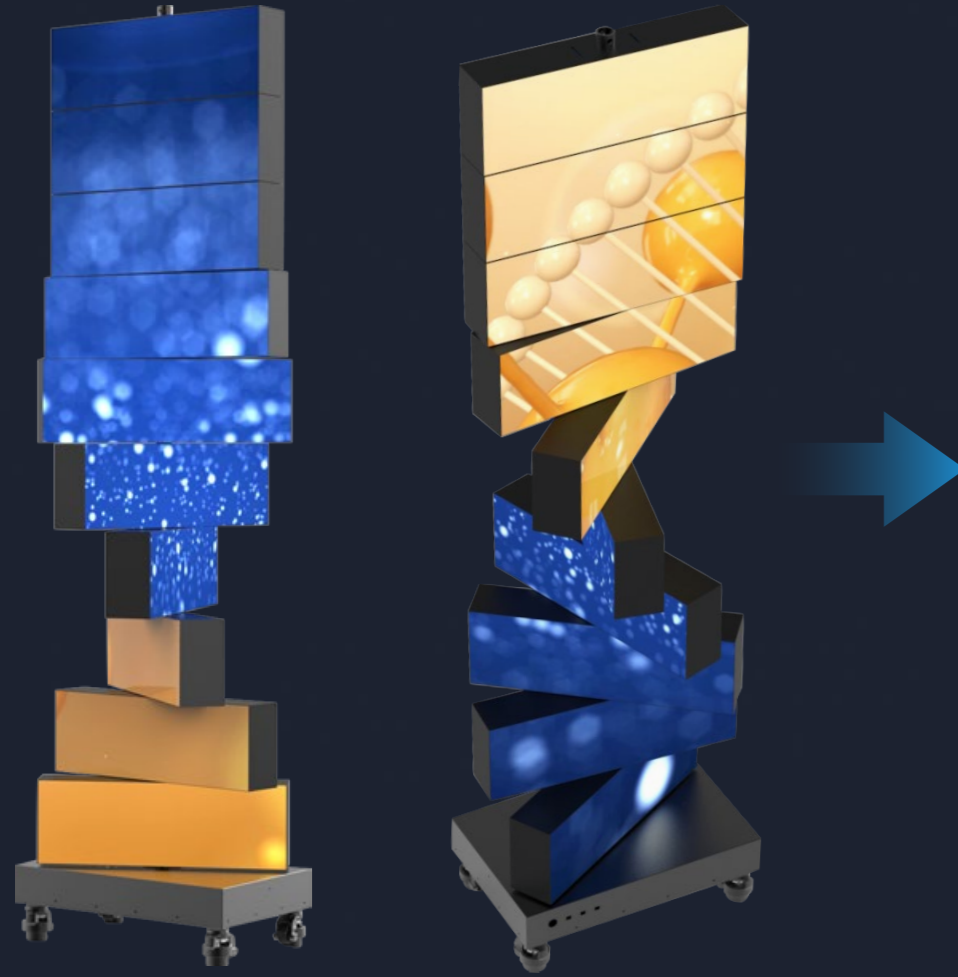

## Model No.4

# Double Sides Kinetic DNA LED Display

One side with LED display, the other side with Mirror



Simple maintenance



Support customization



High operational stability



Stable and reliable



Flexible action editing



Support central control invocation



Support infinite rotation



Simple and convenient installation

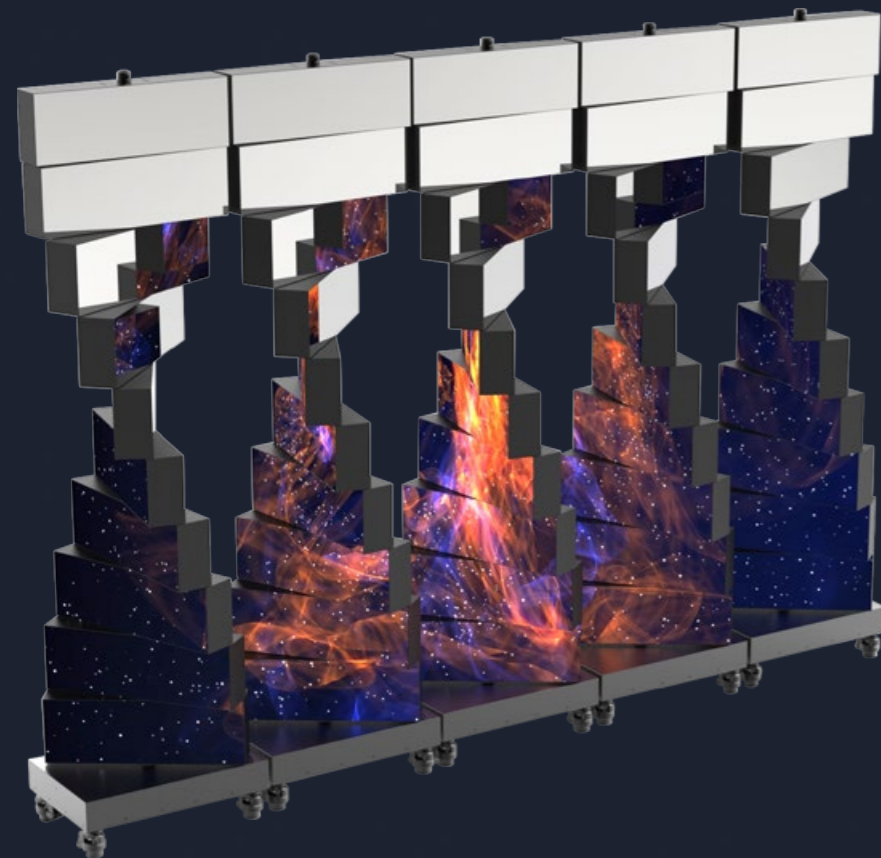

## Specification



Items	Description	Specification
	LED Display Model	Indoor P1.953mm LED Display
	LED Module Size	250 x 250mm
	Number of the Layers	10 (Can be Customized)
	Number of the Units	Multiple Units can be Spliced and Displayed Simultaneously
	Each Unit Dimension	Length: 754mm; Thickness: 138mm; Height: 2830mm.
	Display Surfaces	One side with LED Display, the other side with Mirror
	Each Layer Display Size	750 x 250mm
	Whole Display Size	750 x 2,500 mm ( WxH )
	Whole Display Resolution	384 x 1,280 pixels ( WxH )
	Gap between Each Layer	2mm
	Net Weight	LED Display: 190 kgs   Base: 86 kgs
	Gross Weight	LED Display: 265 kgs   Base: 121 kgs
	Moving Range	360° unlimited rotation
	Motion Mode	Built-in motion scripts ( user-editable ) Or with software-adjustable motion script parameters
	Operation Speed	The rotation and opening / closing speeds are adjustable via the control program
	Control Category	Network-based control via TCP/IP protocol
	Video Binding Capability	Yes (1 video file per motion script)
	Multi-Script Support	Yes (Multiple videos can be mapped to multiple motion scripts)
	Protocol Support	External UDP-based invocation protocol
	Self-Recovery Functionality Supported	Software-enabled automatic error detection and clearance
	Power Input	AC 110 ~ 240V, 50/60HZ
	Max. Power Consumption	3.5 KW
	Signal Transmission	CAT 6
	Installation	Factory Configuration: Display panel and base shipped as separate units. Installation requires upright positioning of panel followed by screw-fastening to base

### Display & Dimension

### Control & Script

### Power & Installation

# Product in Action

( Double Sides Kinetic DNA LED Display )

